

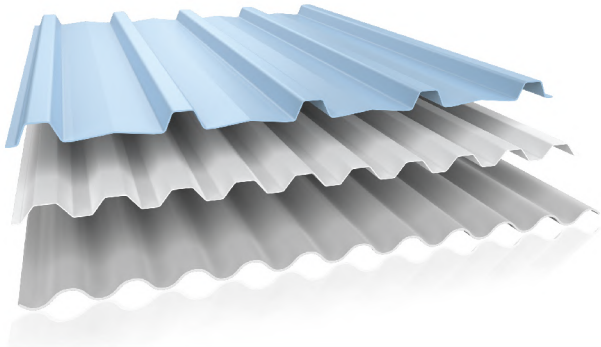

 **Alderon**  <sup>®</sup>

**PREMIUM uPVC CORRUGATED ROOFING**



**Alderon RS is a single-ply uPVC roof, designed to meet a longer term solution for roofs that demand high performance at a lower life cycle cost.**

Alderon RS adalah atap uPVC single layer yang didesain untuk memenuhi kebutuhan atap yang dapat bertahan lama dengan harga yang terjangkau.

## REASONS WHY YOU SHOULD USE Alderon RS

### Alasan Untuk Memakai Alderon RS

- 1 Strong Kuat**
- 2 Light Weight Ringan**
- 3 Durable Tahan Lama**
- 4 Corrosion Free Tidak Berkarat**
- 5 Self Extinguishing Padam Sendiri Jika Terbakar**
- 6 Easy to Fabricate Mudah Difabrikasi, Mudah dipotong, dilubangi dan mudah dipasang bahkan dengan peralatan standar**
- 7 Chemical Resistance Chemical Resistant uPVC Roof Tahan Kimia Atap uPVC yang tahan terhadap bahan kimia berbahaya**

Profile Illustration Ilustrasi Profil	Thickness Tebal (mm)	Width Lebar (mm)	Effective Width Lebar Efektif (mm)	Height Tinggi (mm)	Pitch Jarak Antar Puncak (mm)	Weight Berat (kg/Lm)	Length* Panjang* (M)	Color Warna
<b>Roma</b> 	1.20	860	764	17	76	2.1	1.8, 2.1, 2.4, 3, 4, 5, 6	Opaque White, Lite Grey, Soft Blue.
<b>Greca</b> 		760	688	17	76	2.01		
<b>Trimdeck</b> 		830	765	29	190.5	2.1		
<b>RS 1000</b> 		1071	1000	30	250	2.67		

\*Length can be customized, subject to minimum quantity | \*Panjang bisa dibuat sesuai permintaan, dengan minimum order

# Installation Guide

## Panduan Instalasi

Step  
**1**

In order for the rainwater to flow down nicely, the recommended roof slope angle is 10° minimum.

Agar air hujan mengalir ke bawah dengan baik, sudut kemiringan atap yang dianjurkan adalah 10° minimum.

Step  
**2**

The recommended maximum purlin distance is 800mm, overlap is 200mm, and overhang distance is 100mm.

Jarak purlin maksimum yang disarankan adalah 800mm, overlap 200mm, dan jarak overhang 100mm.

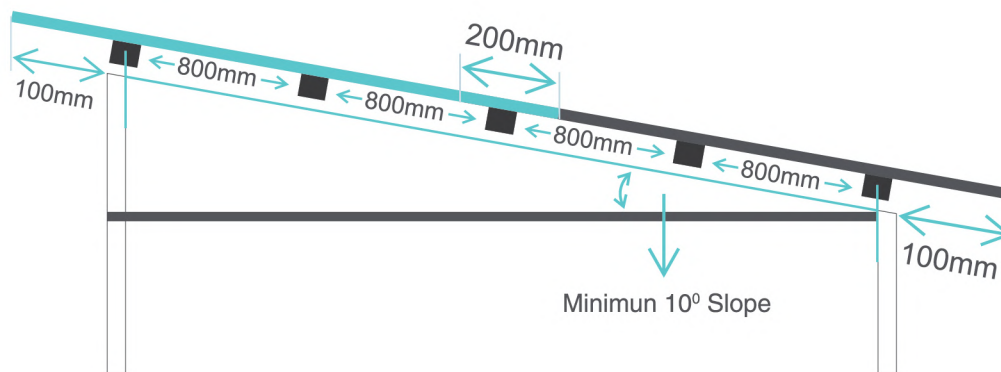

Step  
**3**

Install Alderon RS with recommended overlap and weather seal.

Pasang Alderon RS dengan overlap yang direkomendasikan dan seal tahan cuaca.

### Recommended Overlap

Rekomendasi Overlap :

Roma : 1½ Gelombang



Greca : 1 Gelombang



Trimdeck : 1 Gelombang



RS 1000 : 1 Gelombang

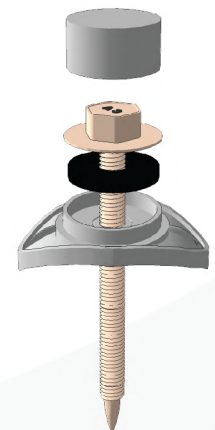

( Weather Seal )



# Supported Accessories

## Aksesoris Penunjang

### Weather Seal

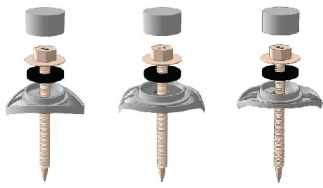

**WS01** (Roma)    **WS02** (Greca)    **WS03** (Trimdeck)

### Nok/Wuwungan



**RS Roma**



**Jurai**



**Three Way**

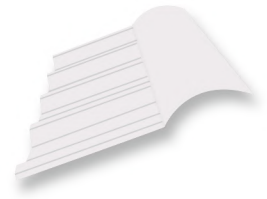

**Trimdeck**

Type	Length
WS01 (Roma)	5 cm
WS02 (Greca)	5 cm
WS03 (Trimdeck)	6 cm

Type	Length (mm)	Width (mm)	Thickness (mm ±10%)	Color
RS Roma	900	600	2.2	Opaque White, Lite Grey, Soft Blue
Jurai	1100	346	2.4	
Three Way	589.8	346.4	2.4	
Trimdeck	815	350	2.3	

## Product Application

### Aplikasi Produk



- **House Roof** / Atap Rumah Tinggal
- **Canopy** / Kanopi



- **Cladding**
- **Atap Bangunan Berkebutuhan Khusus** (Pernakan, Pabrik Kimia, Pabrik Pupuk)

Manufactured by / Diproduksi oleh :



**UPC** **PT. Unipack Plasindo**  
PLASTIC  
a subsidiary of **PT Impact Pratama Industri Tbk**  
*Excellence through Passion*

Distributed by / Didistribusikan oleh :



For more Alderon products ranges, please visit [www.alderon.co.id](http://www.alderon.co.id)

@alderonrs @alderonrs